

# Gallag

## DIP SWITCH A

DIP SW A	1	2	3	4	5	6	7	8
The Number of Coins and Plays	ON	ON	ON	1 COIN	7 PLAYS			
	ON	ON	OFF	1 COIN	6 PLAYS			
	ON	OFF	ON	1 COIN	3 PLAYS			
	ON	OFF	OFF	1 COIN	2 PLAYS			
	OFF	ON	ON	1 COIN	1 PLAY			
	OFF	ON	OFF	2 COINS				
	OFF	OFF	ON	2 COINS				
	OFF	OFF	OFF	2 COINS				
EXTRA SCORE	1st 20000 Points			ON	ON	OFF		
	2nd 60000 Points							
	1st 30000 Points			ON	OFF	ON		
	2nd 80000 Points							
	1st 20000 Points			ON	OFF	OFF		
	2nd 50000 Points							
	1st 20000 Points			OFF	ON	ON		
	2nd 60000 Points							
	1st 30000 Points			OFF	ON	OFF		
	2nd 70000 Points							
			OFF	OFF	ON			
			OFF	OFF	OFF			
The Number of GALLAG		1				ON	ON	
		2				ON	OFF	
		3				OFF	ON	
		5				OFF	OFF	

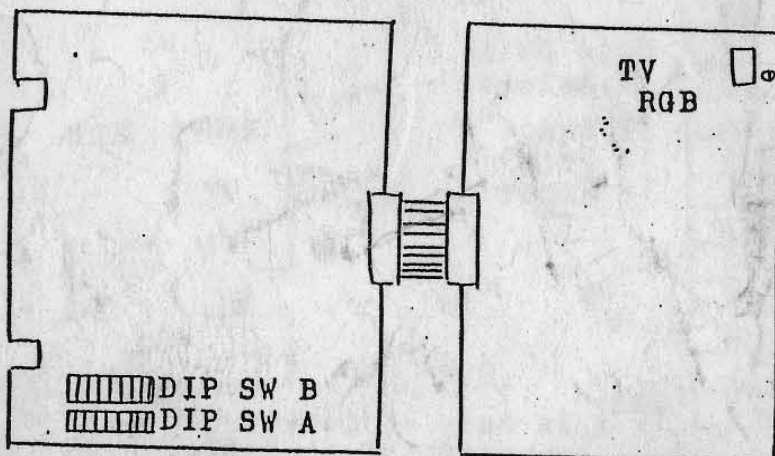

DIP SWITCH B

DIP SW B	1	2	3	4	5	6	7	8
Attract Sound	ON			ON				
	OFF			OFF				
Scene	STOP				ON			
	NORMAL				OFF			
Slection of Stage	STAGE PROCESS					ON		
	NORMAL					OFF		
Rank	ON	ON	A					
	ON	OFF	B					
	OFF	ON	C					
	OFF	OFF	D					
Coin Switch A	1 COIN 1PLAY				ON	ON		
	1 COIN 2PLAYS				ON	OFF		
	2 COINS 1PLAY				OFF	ON		
	2 COINS 3PLAYS				OFF	OFF		

Solder Side Parts Side

GND	[	A	1	)	GND
		B	2		
+5	[	C	3	)	+5
		D	4		
+12		E	5		+12
Sound		F	6		
		H	7		
		J	8		
		K	9		
		L	10		
		M	11		
		N	12		
		P	13		
		R	14		
		S	15		
		T	16		
		U	17		
		V	18		
+5	[	W	19	)	+5
		X	20		
GND	[	Y	21	)	GND
		Z	22		

TV (Small Printed Circuit Board)

GND	5	1
SYNO	4	
B	3	
G	2	
R	1	

Coin SW B  
2P Select  
2P Shoot  
2P Left  
2P Right

Coin SW A  
1P Select  
1P Shoot  
1P Left  
1P Right

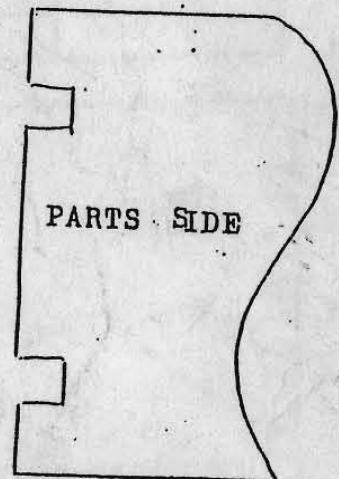

In case of Cocktail Type connect the connector U to GND.

# Ga Uay

No. 2

EIP SW

SWA RM22

1	2	3	4	5	6	7	8	
OFF	OFF	OFF						1 COIN / CREDIT
		ON						1 " 2 "
		ON						1 " 3 "
		ON	ON					2 COINS3 "
		ON						2 " 1 "
	ON							3 " 1 "
	ON	ON						4 " 1 "
	ON	ON	ON					FREE PLAY (SERVIS SW)
				ON				1st BONUS 20000 pts, 2nd BONUS 60000 pts.
		ON	ON					" 20000 " 60000 , and EVERY 60000 pts
2.3.4		ON	ON					" 20000 " 70000 " 70000
Ships		ON						" 20000 " 80000 " 80000
		OFF	OFF	OFF				" 30000 " 80000 "
		ON	ON					" 30000 " 100000 , and EVERY 100000 pts
		ON						" 30000 " 120000 " 120000 "
		ON	ON	ON				BONUS NOTHING
				ON	ON			1st BONUS 30000 pts, 2nd BONUS 100000 pts.
				ON				" " " 120000 "
5 Ships				ON	ON			" " " 150000 , and EVERY 100000 pts
only				ON	ON			" " " 100000 " 120000 "
				ON	ON			" " " 120000 " 150000 "
				ON				" " " 150000 " "
				OFF	OFF	OFF		BONUS NOTHING
				ON	ON	ON		5 SHIPS
				OFF	OFF			4 "
				ON				3 "
				ON	ON			2 "

SWB RM21

1	2	3	4	5	6	7	8	
OFF	OFF	OFF		OFF	OFF	OFF	OFF	GAME RANK A
ON	ON							" B
		ON						" C
		ON						" D
			ON					
			OFF					

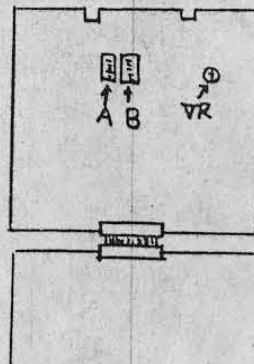

GALLAGA A1

Universal Video

NEW



Unten  
SOLDER SIDE

Oben  
PARTS SIDE

T. V. (SHALL BOARD)

1	GND	1	GND	1
2		2		
3	+5	3	+5	2
4		4		
5	+12	5	+12	3
6	SOUND	6	Sinck	204
7		7	Blau	203
8		8	grün	202
9		9	Rot	201
10		10		
11	Tilt	11	Coin	
12	Coin	12	COIN SW	101
13	SELECT	13	IP SELECT SW	102
14	2P FIRE	14	1P FIRE	104
15	2P LEFT	15	1P LEFT	104
16	2P RIGHT	16	1P RIGHT	105
17		17		
18		18		
19	+5	19	+5	2
20		20		2
21	GND	21	GND	2
22		22		

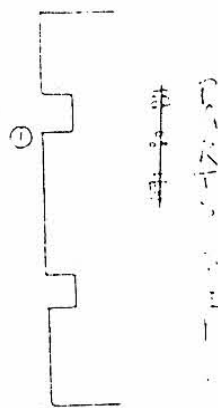
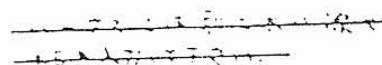
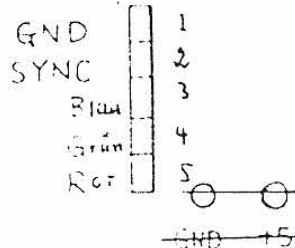

テーブルタイプで使用する場合は  
半田面の17番とGNDとを  
ジャンパーする

IF YOU WANT TO USE AT  
TABLE TYPE | PLEASE CONNECT  
NO.17 & GND OF SOLDER SIDE  
BY JUMPER WIRE.

Bestückungsseite  
Oben

bei Tisch "17" unten auf GND

